

PREMIUM PASTE LINE CASING

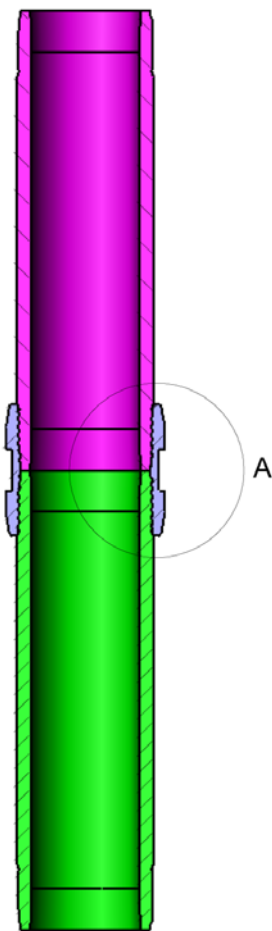

SECTION A-A

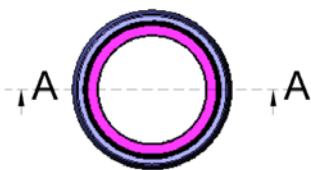

Ozcon Engineering's innovative Premium Paste Line (PPL[®]) casing and connection range has been tried and proven for a number of years resolving the issues that traditional paste fill lines had with premature wear and failure.

DESCRIPTION

Threaded and Coupled Premium Paste Line Connection (PPL[®])

PPL[®] Sizes: 4 ½" 5 ½" 6 ⅝" 8 ⅝" 10 ¾"

PPL-S[®] Sizes: 4 ½" 5 ½" 5 ⅞" 6 ⅝" 8 ⅝"

APPLICATIONS

The PPL[®] connection was designed to replace the casing used in traditional paste filling operations. Paste filling is a method used to dispose of mine tailings underground, to backfill underground mine stops or to achieve both simultaneously. However using welded steel casing for paste filling leads to problems. The casing, string of steel or PVC pipe traditionally used tends to suffer premature wear and frequently needs replacing, re-drilling or full re-installation. Ozcon's designed PPL[®] connection range solves this issue through using a premium threaded connection, controlling velocity (which reduces areas of wear) and by using a heavier wall thickness than traditional casing making it less likely to wear through or fail.

BENEFITS

Threaded connection – using a threaded connection eliminates all welding that was traditionally required resulting in increased safety and reducing costs

Running control – Ozcon's PPL[®] can be run using raisebore drilling rigs as opposed to needing separate cranes and running gear. All drilling and casing can be completed in the one rig and process steps, offering a unique advantage over all other products on the market

Running time – the team at Ozcon have worked with our clients to monitor running time and total job efficiency and all clients to date have found significant time savings and reduced running costs compared to replaceable casing and/or welded casing.